



Imaged Document Cover Sheet

The document following this cover sheet is an imaged document supplied by LANDATA®, Land Use Victoria.

Document Type	Plan
Document Identification	CP161649U
Number of Pages (excluding this cover sheet)	1
Document Assembled	16/01/2019 11:42

Copyright and disclaimer notice:

© State of Victoria. This publication is copyright. No part may be reproduced by any process except in accordance with the provisions of the Copyright Act and for the purposes of Section 32 of the Sale of Land Act 1962 or pursuant to a written agreement. The information is only valid at the time and in the form obtained from the LANDATA® System. The State of Victoria accepts no responsibility for any subsequent release, publication or reproduction of the information.

The document is invalid if this cover sheet is removed or altered.

OFFICE USE ONLY
CP 161649 U

NOTATIONS

LITHO SH. 2

CERTIFICATION BY SURVEYOR

I CERTIFY THAT THIS PLAN HAS BEEN MADE BY ME OR UNDER MY IMMEDIATE SUPERVISION AND ACCORDS WITH TITLE

H. Goodison
 LICENSED SURVEYOR
 DATE 14-11-85

PLAN APPROVED

H. Goodison
 REGISTRAR OF TITLES
 14/3/86

THE LAND TO BE CONSOLIDATED IS SHOWN ENCLOSED BY CONTINUOUS THICK LINES
 TITLE REF: VOL 9661 FOL 825 VOL 9661 FOL 826
 LAST PLAN REF:

PLAN OF CONSOLIDATION

COUNTY **BOURKE**
 PARISH **MELBOURNE SOUTH**
 CITY OF **SOUTH MELBOURNE**
 SECTION **85**
 CROWN ALLOTMENTS **40 & 41**

ORIGINAL SCALE 1:500 SHEET SIZE A3
 LENGTHS ARE IN METRES

OFFICE USE ONLY
CP 161649 U

VICTORIA

CP161649U

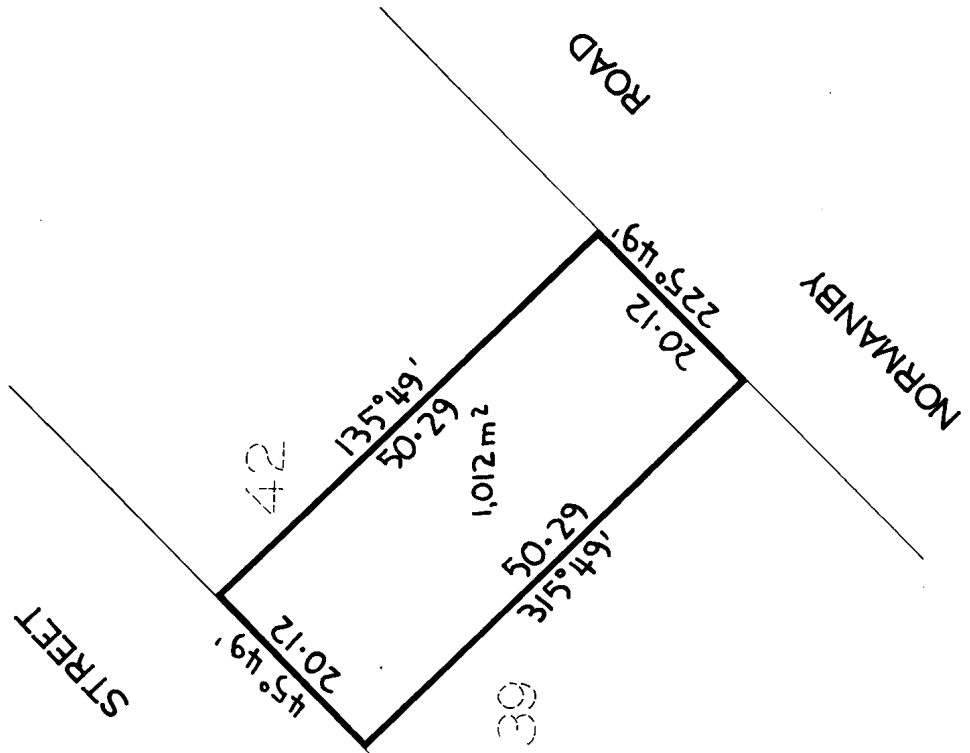

MUNICIPALITY SEAL AND ENDORSEMENT OF MUNICIPALITY COUNCIL REF.

Sealed Pursuant to the provisions of Sec. 569 A B of the Local Gov. Act
 This Plan of Consolidation of Titles was approved by the Council of the City of South Melbourne on 16th December, 1985 and has been sealed pursuant to Section 569AB of the Local Government Act.
 As witness whereof the Corporate Seal of the Mayor, Councillors and Citizens of the City of South Melbourne was affixed hereto this 17th day of December 1985 in the presence of -

R. S. [Signature]
 MAYOR
[Signature]
 COUNCILLOR
 CHIEF ADMINISTRATIVE OFFICER *[Signature]*

SURVEYORS REF.
5904/6

K.J. GOODISON & ASSOCIATES
 LICENSED SURVEYORS
 301 BRIDGE ROAD RICHMOND 3121
 TEL: 4781818

0 10 20 30 40 50 60 70 80 90 100 110 120 130 140 150mm

5mm