

# Yarra River – Bulleen Precinct Land Use Framework Plan

Community update | August 2020



## Your chance to guide the future of the Yarra River (Birrarung) through the Yarra River – Bulleen Precinct Advisory Committee process

The Department of Environment, Land, Water and Planning has prepared an updated 2020 draft of the Yarra River – Bulleen Precinct Land Use Framework Plan, recommending a range of future land use changes and connections for the area of the Yarra River (Birrarung) encompassing parts of Bulleen, Heidelberg and Lower Templestowe.

Important updates to the draft plan have been made following a public submissions period in May-June 2019 and the deferral of the Yarra River – Bulleen Precinct Advisory Committee hearings at that time.

### An aligned community vision for the Yarra River (Birrarung)

The 2020 draft plan brings to life a vision for a healthy river and environment, a thriving arts and cultural scene and connected people and places. It aligns with the 50-year Community Vision for the Yarra River established as part of the Yarra Strategic Plan in 2018, while providing a more detailed framework for future land use and development through this iconic part of the river's suburban reach.

Through community consultation, you told us it was important to:

- improve the river's environmental health
- celebrate cultural and heritage values
- protect visual landscape through land use planning
- improve community use and access
- create a 'world class cultural precinct'.

We are now seeking your feedback on the 2020 draft plan, which proposes:

- a continuous open space connection on the eastern (Manningham) side of the river
- new pedestrian and cycling links, better connection to the river and improved north-south access
- new pedestrian and cycling bridges across the river with stronger physical connections to the Heidelberg activity centre

- an expanded cultural precinct – building on the Heide Museum of Modern Art – and places for new cultural facilities
- delivery of new open space, recreation and conservation areas, ecological connections and revegetation
- investigation of road access improvements, including the future widening of Templestowe Road.

### Yarra River – Bulleen Precinct Advisory Committee

The Minister for Planning has appointed an advisory committee to make recommendations on the 2020 draft plan and an updated private development proposal for the Yarra Valley Country Club. The Yarra River – Bulleen Precinct Advisory Committee will exhibit updated materials, receive submissions and conduct public hearings before making recommendations to the Minister.

You can find out more about the advisory committee process, including how to make a submission, on the back page of this community update and by visiting the Engage Victoria website:

[engage.vic.gov.au/yarra-river-bulleen-precinct-advisory-committee](https://engage.vic.gov.au/yarra-river-bulleen-precinct-advisory-committee)

### Our updated land use framework

The 2020 draft plan outlines a proposed new spatial framework – as summarised in the map on the following page – to deliver these priority objectives:



#### OBJECTIVE 1

Ecological and parkland connections



#### OBJECTIVE 2

Access for the future



#### OBJECTIVE 3

An internationally significant cultural precinct



#### OBJECTIVE 4

A complementary mix of uses

# YARRA RIVER - BULLEEN PRECINCT

## LAND USE FRAMEWORK PLAN SUMMARY MAP

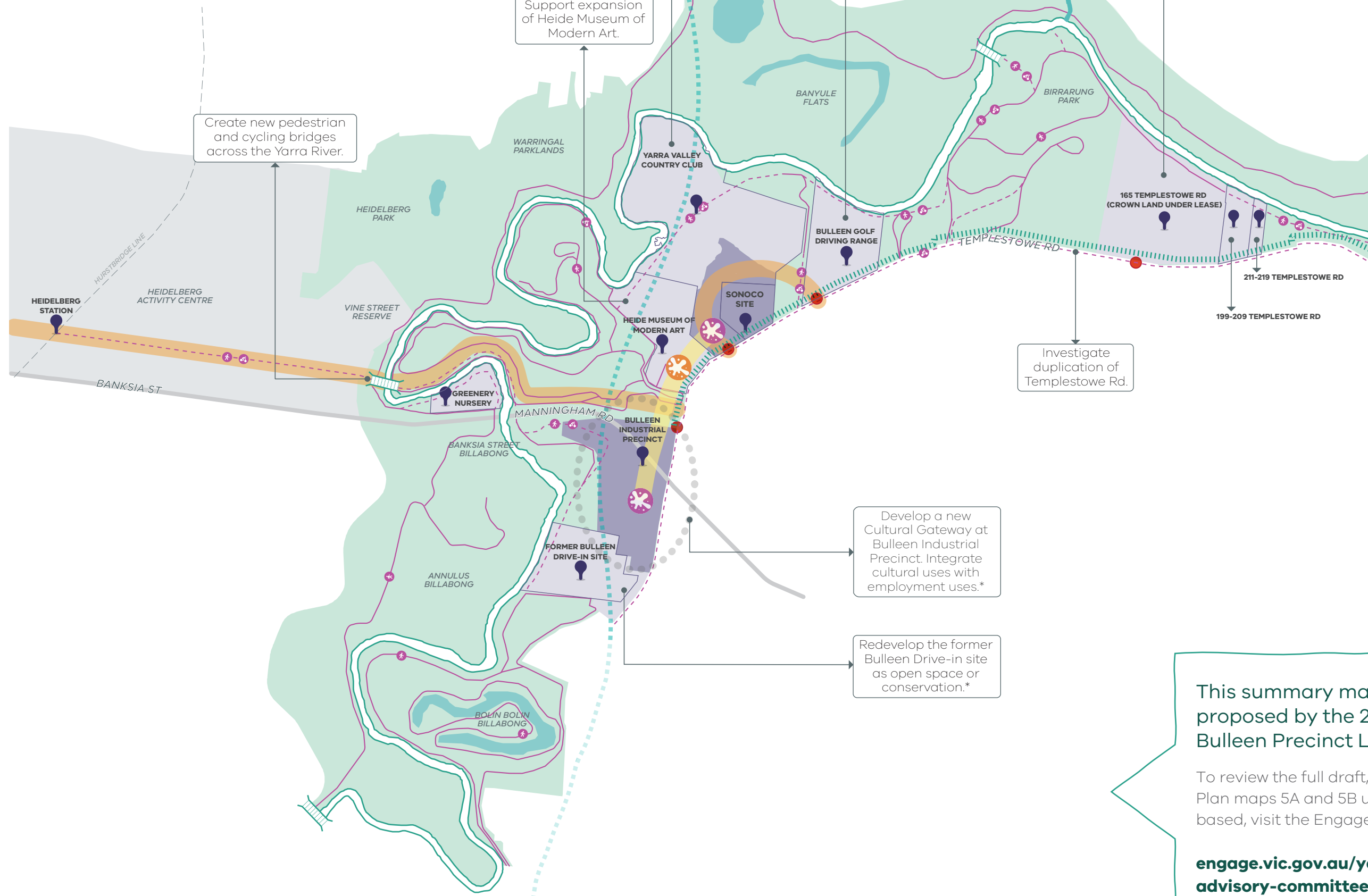

### Legend

- Project boundary
- Yarra River
- Billabong/water body
- Key site
- North East Link proposed alignment
- Heidelberg Activity Centre
- Existing walking path
- Existing cycling path

### Proposed improvements

- Expansion of parklands/ecological connections/active recreation
- Development opportunities
- Key circulation
- Cultural 'core'
- Expanded cultural place
- Cultural place
- Cultural Gateway
- Walking path
- Cycling path
- Road widening/duplication
- Signalised intersection
- Bridge connection

\* subject to North East Link Infrastructure requirements

© The State of Victoria Department of Environment, Land, Water and Planning 2020

This summary map shows the key changes proposed by the 2020 draft Yarra River – Bulleen Precinct Land Use Framework Plan

To review the full draft, including the Land Use Framework Plan maps 5A and 5B upon which this summary map is based, visit the Engage Victoria website:

[engage.vic.gov.au/yarra-river-bulleen-precinct-advisory-committee](https://engage.vic.gov.au/yarra-river-bulleen-precinct-advisory-committee)

## Making a submission to the advisory committee

The Yarra River – Bulleen Precinct Advisory Committee will be exhibiting all updated plans through the Engage Victoria website:

**[engage.vic.gov.au/yarra-river-bulleen-precinct-advisory-committee](https://engage.vic.gov.au/yarra-river-bulleen-precinct-advisory-committee)**

Online submissions are preferred and can be made via the website until 5pm on Friday 25 September 2020. If you wish to make a hardcopy written submission, this must be accompanied by a signed coversheet available by calling Planning Panels Victoria on (03) 8624 5714. Each written submission must have its own coversheet and they cannot be copied. All submissions must state the name and address of the person making the submission. Submissions will be treated as public documents and will be published on Engage Victoria.

When making your submission you can also nominate to be heard as part of the Advisory Committee's public hearing. Submitters will be notified about the timing and location of the hearings after the exhibition period has closed. Anyone seeking to be heard at the public hearing is required to submit a written submission.

Acknowledging the contribution of submitters during the May-June 2019 exhibition period, submissions received at that time will still be considered by the

Advisory Committee – and while you have the option of updating your submission, there is no requirement that you do so. Submitters who nominated to be heard in person by the Advisory Committee in 2019 will again be invited to do so. If you previously made a submission in 2019, you will be notified about the timing and location of the hearings after the exhibition period has closed.

## North East Link

Following the approval of the North East Link project and the commencement of early works, the 2020 draft plan has been updated to reflect the impacts of the project, including the latest plans for the relocation and replacement of open space and recreation facilities in the precinct.

For more information on the North East Link, visit: **[northeastlink.vic.gov.au](https://northeastlink.vic.gov.au)**

## Advisory Committee key dates

Exhibition period opens	Exhibition period closes	Directions hearing	Public Hearing commences
31 Aug 2020	25 Sep 2020	14 Oct 2020	9 Nov 2020



## Have your say

The Yarra River – Bulleen Precinct Advisory Committee is exhibiting the 2020 draft plan, as well as updated plans for private development of the Yarra Valley Country Club, over a four-week period. The Advisory Committee is inviting you to review and have your say on exhibited materials and make a submission by **5pm on 25 September 2020**.

To read the 2020 draft plan and make a submission, visit:

**[engage.vic.gov.au/yarra-river-bulleen-precinct-advisory-committee](https://engage.vic.gov.au/yarra-river-bulleen-precinct-advisory-committee)**

## Accessibility

If you would like to receive this publication in an alternative format, please telephone the DELWP Customer Service Centre on 136 186, or email [customer.service@delwp.vic.gov.au](mailto:customer.service@delwp.vic.gov.au), or via the National Relay Service on 133 677, [www.relayservice.com.au](http://www.relayservice.com.au)

ISBN 978-1-76105-245-3 (pdf/online/MS word)

© 2020 The State of Victoria Department of Environment, Land, Water and Planning.



Environment,  
Land, Water  
and Planning